



## C6000G-S 12v ELECTRIC WINCH

The **C 6000 G-S** Compact design and High Performance ensure the C6000 G-S is the ideal choice for light recovery. The highly efficient series Wound Motor and Robust 3 Stage Planetary Gearing provide Reliability with unbeatable value for money. Heavy duty waterproof contactors as standard Ideal for flat bed, trailer or self recovery applications.

### STANDARD FEATURES.

- **MOTOR** : Powerful, Reliable Reversible 3.6hp Heavy Duty Series Wound Motor
- **SOLENOIDS**: Waterproof inside heavy duty steel casing mounted over the drum
- **GEARING** : Specially treated 3 stage planetary
- **DRUM**: Steel Mounted on Maintenance Free Bearings.
- **CLUTCH**: Ring clutch System for Free Spooling.
- **BRAKE** : Automatic Failsafe In The Drum
- **MOUNTING**: Comes with mounting bracket as standard
- **WINCH** : Manufactured under ISI9001 Systems to CE Standard

### STANDARD ACCESORIES

- 32m of 7.2 mm galvanized aircraft cable
- 4m Durable Remote Handset with Long Lead
- Heavy Duty Roller Fairlead
- Heavy duty battery lead and terminals
- 5/16<sup>th</sup> hook

### SPECIFICATION

- Rated Pull Line 6000lb (2722kg)
- 3.6hp/2.5kw Series Wound Motor
- Gear Reduction 294:1
- Drum Size 63mm x 228mm
- Overall Dimensions (LxWxH) 536mm x 180mm x 270mm
- Mounting Pattern 254mm x 114.3mm
- Weight 32kg

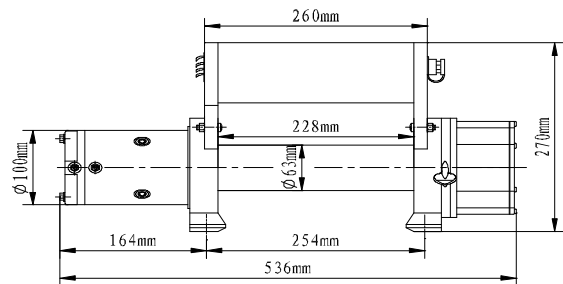

LINE PULL lbs (kgs)	CURRENT 12V A	CURRENT 24V A
0	45	25
2000(907)	100	65
4000(1814)	210	120
6000(2722)	260	200

LAYER	RATED LINE PULL lbs (kgs)	ROPE ON THE DRUM ft(m)
1	6000(2722)	21.3(6.5)
2	5000(2268)	47.5(14.5)
3	4200(1905)	77.0(23.5)
4	3700(1678)	105(32.0)

### OPTIONAL ACCESSORIES

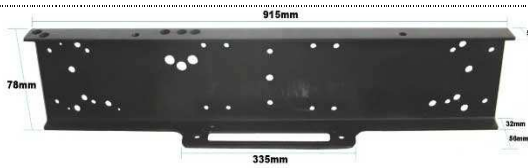

INSTALLATION PLATE



WIRELESS REMOTE



WINCH KIT



PLASMA 12



AL FAIRLEADS